

HOTEL FACILITIES

Located strategically between main attractions and Florence International Airport, adjacent to main highways A1/A11

- 212 guests rooms including 4 Suites and Executive floor with the Executive Lounge
- Relaxation Area with Mega-Whirlpool, Swedish waterfall and chromotherapy.
- Fitness Centre open 24/7
- Luci della Città Restaurant
- Lounge Bar
- Business Station
- Hilton Shuttle bus of 29 seats
- Congress Centre for up to 1000 delegates

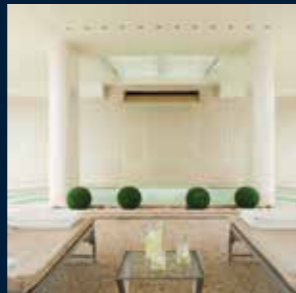
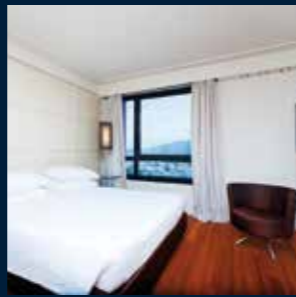

CONFERENCES & EVENTS



Room name	LxWxH (metres)	Sam	Sqf	Boardroom	U-shape	Theatre	Classroom	Banquet	Reception	Cabaret
A	7.50X4.50X5.20	34	366	16	15	20	12	\	\	6
B	7.50X5.90X5.20	44	474	22	20	40	24	24	\	12
C	7.50X4.50X5.20	34	366	16	15	20	12	\	\	6
D	14.72X16.74X5.20	246	2648	52	42	250	126	150	250	76
E	7.50X4.50X5.20	34	366	16	15	20	12	\	\	6
F	7.50X5.90X5.20	44	474	22	20	40	24	24	\	12
G	7.50X4.50X5.20	34	366	16	15	20	12	\	\	6
A+B	7.50X10.40X5.20	78	839	28	24	60	36	48	50	24
B+C	7.50X10.40X5.20	78	839	28	24	60	36	48	50	24
A+B+C	7.50X14.17X5.20	106	1141	40	42	100	54	64	150	36
E+F	7.50X10.40X5.20	78	839	28	24	60	36	48	50	24
F+G	7.50X10.40X5.20	78	839	28	24	60	36	48	50	24
E+F+G	7.50X14.17X5.20	105	1130	40	42	100	54	64	150	36
A+B+C+D	14.17X26.30X5.20	373	4015	108	90	350	201	276	350	90
D+E+F+G	14.17X26.30X5.20	373	4015	108	90	350	201	276	350	90
A+B+C+D+E+F+G	14.50X34.60X5.20	500	5382	138	117	520	300	330	500	168
H	14.20X12.00X3.80	170	1829	40	48	150	96	96	200	42
I	14.20X12.00X3.80	170	1829	40	48	150	96	96	200	42
L	14.20X12.00X3.80	170	1829	40	48	150	96	96	200	42
H+I	14.20X26.20X3.80	340	3659	\	\	320	180	192	350	72
H+I+L	14.50X34.60X3.80	500	5382	\	\	520	300	330	500	168
I+L	14.20X26.20X3.80	340	3659	\	\	320	180	192	350	72
FOYER	11.00X26.00X4.50	286	3078.5	\	\	\	\	\	300	\

florencemetropole.hilton.com

HILTON FLORENCE METROPOLE

Via del Cavallaccio 36 | Florence | Italy
T: +39 055 7871 | F: +39 055 7871 8020
E: florencemetropole_events@hilton.com



HERE ON BUSINESS

MEETING & EVENTS

Create a successful and memorable event at the Hilton Florence Metropole.

The Conference Centre has versatile function spaces combined to state-of-the-art technology.

The Hilton Florence Metropole offers 2 large meeting rooms of 500 sqm each, divided into 10 smaller meeting rooms of different sizes. Whatever the occasion or request is, a professional Conference & Events Team will be there to assist with planning a successful event.



DISCOVER A MAGICAL FLORENCE

Choose Hilton Florence Metropole and the answer is certain to be very exceptional indeed – with all the Florentine magic that only we can offer.

Because, in addition to being the largest Hotel conference centre in the city, we are also your prime choice in so many other ways. From first to last, our combination of meticulous planning, flawless service and elegant style will delight your delegates and guests.

Ground Floor

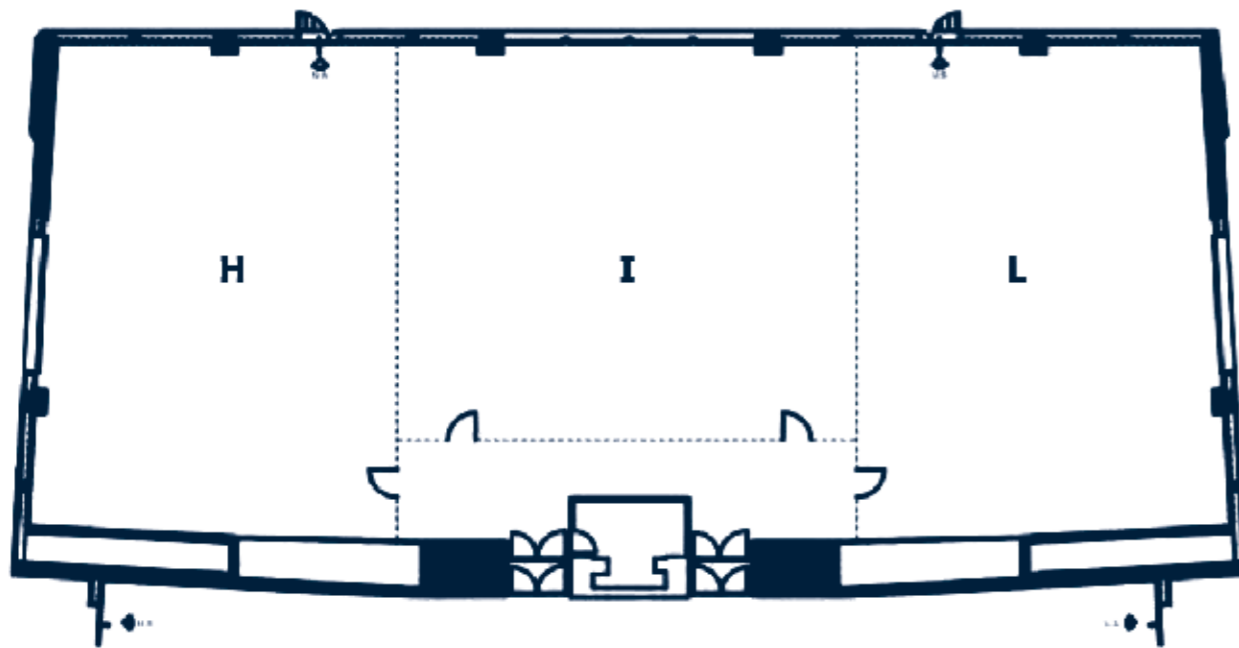

First Floor

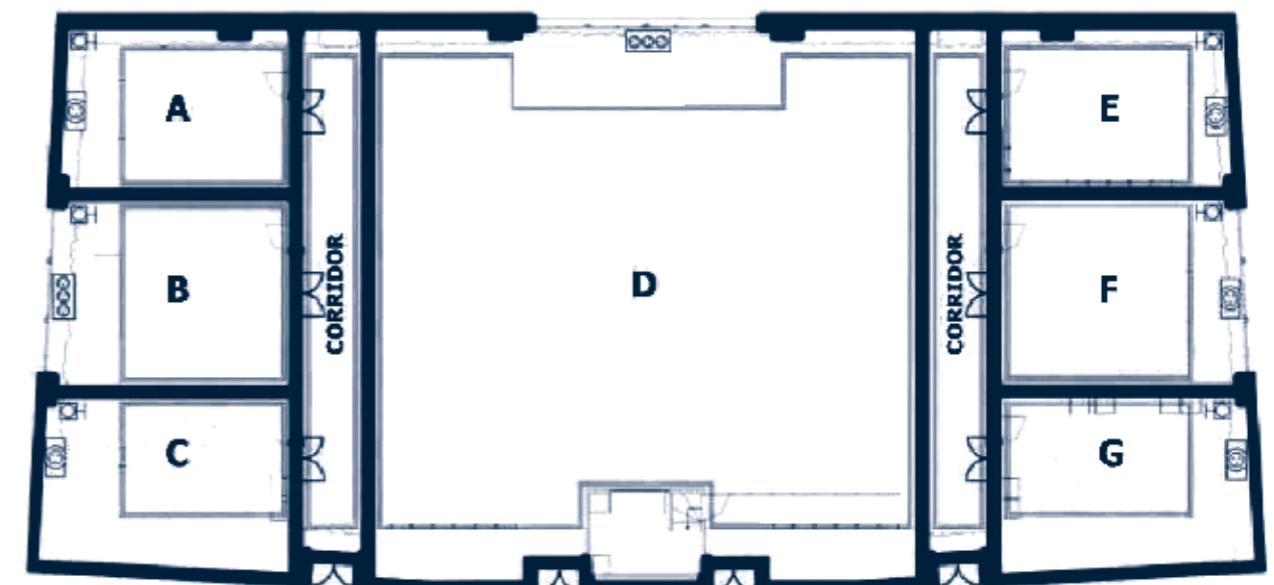

MEETING ROOM GROUND FLOOR

- Ballroom of 500 sqm
- Ceiling 3.80 metres
- Divided into 3 sections of 165 sqm each
- Independent entrances
- All soundproofed and air-conditioned
- No pillars
- Natural daylight

The meeting room on the ground floor has 3 sliding doors with direct access to the hotel parking allowing easy loading of materials for exhibitions and car launches.

Hilton Florence Metropole is the ideal solution for showrooms and defilés; the large parking space is flexible to organize some outside exhibition areas.

MEETING ROOM FIRST FLOOR

- Ballroom of 500 sqm
- Ceiling 5.20 metres
- Divided into 7 sections of different size
- Independent entrances
- All soundproofed and air-conditioned
- No pillars
- Natural daylight

AT A GLANCE

- Flexible space for up to 1000 delegates
- 10 conference and meeting rooms for individual use or breakout sessions
- Banqueting and dining for up to 350 guests
- High speed wireless internet access
- In-house Audiovisual & Events Production team
- Foyer with 350 sqm of exhibition area and natural daylight

